

CALIBRATION FIXTURE

The FCC-BCICF-6-150 has been designed for the IEC 61000-4-6 Ed 4.0, section 6.2.3.1 – 6.2.3.2 that states "...the increase of the transmission loss of the test jig, produced by the insertion of the Current Clamp, shall not exceed 1.6 dB". This 1.6 dB requirement is verified by subtracting the insertion loss of the calibration fixture without the Clamp in place from the fixture insertion loss with the Clamp in place.

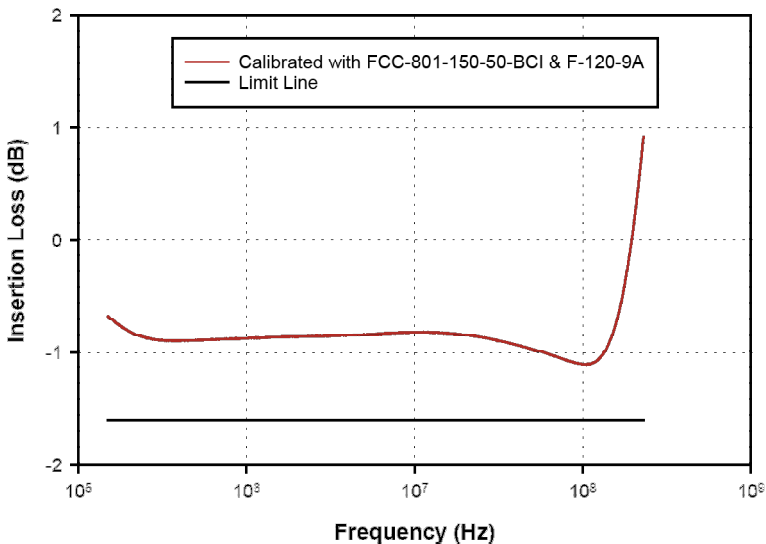
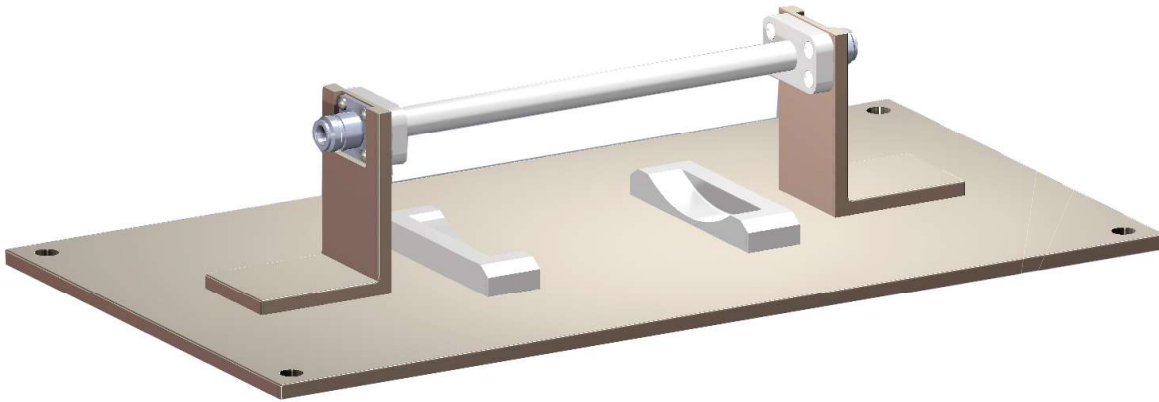

Specifications

Frequency: 150 kHz – 230 MHz
 Insertion Loss: <1.6 dB
 Dimensions: (L x W x H) 432 mm x 229 mm x 80 mm
 Weight: 2.2 kg

Accessories

Passive Impedance Adapters: FCC-801-150-50-BCI



Fischer Custom Communications, Inc.

20603 Earl St., Torrance, CA 90503
 Phone: 310-303-3300
 Fax: 310-371-6268
 Email: sales@fischercc.com

© Fischer Custom Communications, Inc.